

千葉県立関宿城博物館

Outline of this museum

Bound by the Tone and Edo rivers, the Sekiyado-jo Museum was built atop a super levee in Sekiyado-Sanganya, Noda City. With a mission to explore a history and culture shaped by rivers, this museum opened its doors to the public in 1995.

In accordance with an exhibition theme defined by rivers and associated industries, the history of the lives of the people living in the Tone River Basin is hereby introduced in a manner that is easy to grasp and comprehend.

Exhibits consist of permanent exhibits that showcase—in terms of a focus on the rivers of the Boso Peninsula, transportation on waterways, and traditional industries—the history of floods and flood control in the Tone River Basin and the culture of industries that were nurtured by rivers and of a presentation entitled *The Sekiyado*

Clan and Sekiyado, which sheds light on the Sekiyado clan as it thrived during the Edo era.

In addition, we conduct investigative research and collect and archive materials concerning history, folklore, and civil engineering as they relate to the rivers of the Boso Peninsula and materials concerning the Sekiyado clan during the Edo era and seek to introduce the results of such efforts to the general public through exhibitions (special and otherwise), lectures, courses, and other activities designed to spread awareness.

A replica of the main tower of the former Sekiyado-jo (Sekiyado Castle) was built to form a portion of the museum structure. The observation room on the fourth floor commands an expansive view of the Tone River and the mountain ranges spanning the entire Kanto region.



Opening hours

09:00 to 16:30
(visitors admitted until 16:00)

Holidays

Mondays (open where a Monday falls on a national holiday or substitute national holiday, in which case this museum will be closed on the following day)
Year-end holidays (December 28 to 31)
Other days may be designated holidays on an extraordinary basis for maintenance or other purposes.

Admission fee

General 200 yen / High school and university students 100 yen
Free for junior high school students and younger; persons 65 years of age and older; and persons presenting an identification booklet for the physically handicapped, certificate for the health and welfare of persons with a mental disorder, or developmental disabilities handbook as well as their care-givers.
(However, please note that fees shall be set on a case-by-case basis during exhibitions and other special events.)

Notes:

- Permission is needed to take photographs inside an exhibition room.
- Refrain from eating, drinking, and smoking outside of designated areas.
- Coin lockers situated by the entrance to this museum can be used to store your belongings.
- Feel free to direct any questions you may have regarding materials to an employee of this museum.
- A museum shop is located in the rest station.

Building outline

Site area: 11,134.81 m²
Total floor area: 2,172.31 m² (including 511 m² corresponding to the main tower)
Exhibition floor area: 714 m² (including 120 m² corresponding to the special exhibition room)

Structure: Steel-reinforced concrete construction with steel frames used in parts, one-story structure complemented by a main tower component [three levels, four stories (in the style of the Fujimi-Yagura tower at Edo Castle)]

Rest station: wooden one-story structure

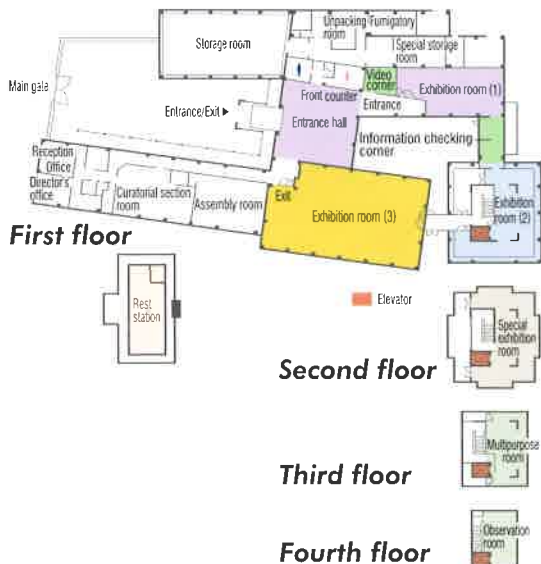

First floor



Second floor

Third floor

Fourth floor

Transportation access

Tobu Railway /

Noda Line: Take the Asahi bus bound for Sakaimachi from Kawama Station and get off at the Sekiyado-jo Museum (32 minutes).

Isezaki Line: Take the Asahi bus bound for Sakai Shako from Tobu Dobutsu Koen Station and get off at Shinmachi Bus Station (27 minutes); walk for 15 minutes to arrive at the Sekiyado-jo Museum.

Mamé bus (runs only on weekdays) /

Take the Mamé bus from Kawama Station (transfer from the northbound route to the Sekiyado-jo route at Sekiyado Chuo Terminal) and get off at the Sekiyado-jo Museum (approximately 70 minutes).

By car /
25 minutes from the Nakazato Bridge on National Route 16, 40 minutes from the Tohoku Expressway Kazo Interchange, or 10 minutes from the Hishinuma Intersection in Saitte City off the Shin 4 Bypass.

Parking / Free parking area is available.

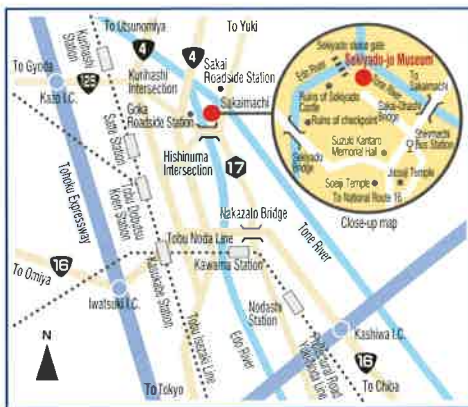

143-4 Sekiyado-Sanganya, Noda-shi, Chiba 〒270-0201

TEL 04-7196-1400 FAX 04-7196-3737

<http://www2.chiba-muse.or.jp/>



Upon entering the hall, visitors to this museum will be greeted by a kappa (mythical water imp) mascot. To invite visitors to explore our exhibition rooms, a diorama presenting a scale model of the town around Sekiyado Castle during the twilight years of the early modern period (just prior to the Meiji Restoration) and the contents of exhibitions hosted by this museum has been set up inside the hall.

Entrance hall

Exhibition room (1)



●The Tone and Edo Rivers During the Modern Era (After the Meiji Restoration)

Visitors are met by a full-size replica of a mizu-zuka (mound used as a shelter), the product of cumulative knowledge gained by people in dealing with periodic floods, as well as various other displays and models presenting an outline of large-scale river-improvement and riparian works conducted on the Tone River Basin, excavation work undertaken for the Tone Canal, and other grand projects carried out since the Meiji Restoration.

Exhibition room (2)

●The Tone and Edo Rivers During the Early Modern Period (Edo Era)

Illustrations and models introduce visitors to large-scale river work undertaken on the Tone River Basin, which began with the eastward relocation of the river itself, as well projects to drain the Tega and Inba ponds and other initiatives carried out at the beginning of the Edo era.



Savor the fun and enjoyment as brought to you by the chronicles of history.



●River Traffic and Traditional Industries

A large-scale model of a Takase boat, a key player when it came to water transportation on the Tone River, occupies the center of this exhibition room and is flanked on both sides by replicas of a waterfront general wholesale store and a soy sauce storehouse. These exhibits introduce visitors to changes in waterway traffic on the Tone River that took place from the Edo Era to the Meiji Restoration and to the culture and customs that evolved over time in line with the development of the banks of this river.



Exhibition room (3)



Special exhibition room

●The Sekiyado Clan and Sekiyado

Except when special exhibitions are on display, materials on the Sekiyado clan and Sekiyado are exhibited in this room. In addition to presenting displays on the history of the Sekiyado clan and on the building and dismantling of Sekiyado Castle, this room also features materials relating to the Kuze clan, from which many members of the shogun's council of elders were drawn.



Observation room

Standing three levels and four stories high, the main tower of this museum rises perceptibly above the super levee on which this site exists. Home of this museum, Noda City is situated more or less in the center of the Kanto Plain. For this reason, the observation room on the top floor of this building commands spectacular views of the Tone and Edo rivers and of the mountains—including Mt. Tsukuba, the Nikko Mountains, and Mt. Fuji—that encircle the Kanto Plain.

